

GLOBAL BUT LOCAL PARTNERSHIP

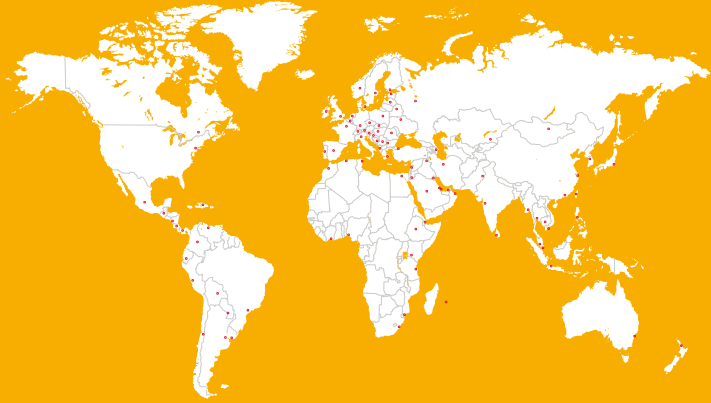

BUILDING TRUST



Sikalastic®-590

Liquid applied membrane for waterproofing of exposed concrete roof with improved water ponding capability

Your Local Sika Partner:

Our most current General Sales Conditions shall apply.
Please consult the most current local Product Data Sheet prior to any use.

Sika Kimia Sdn Bhd
No.9, Jalan Timur,
46000 Petaling Jaya, Selangor
Phone 03 7957 0111
Fax 03 7956 7291
www.sika.com.my

© Sika Kimia Sdn Bhd / 09.2019



BUILDING TRUST



Sikalastic®-590

LIQUID APPLIED MEMBRANE FOR WATERPROOFING OF EXPOSED CONCRETE ROOF WITH IMPROVED WATER PONDING CAPABILITY

USES

Waterproofing membrane for:

- Both new construction and refurbishment projects
- For roofs with many details and complex geometry, where accessibility is limited
- For cost efficient life cycle extension of failing roofs
- For reflective coating to enhance energy efficiency by reducing cooling costs (Sikalastic®-590 White)

KEY ADVANTAGES

- Good behavior under limited water ponding
- UV resistant and resistant to yellowing and weathering
- Highly elastic and crack-bridging
- Non-toxic and VOC compliant water based coating
- One component - ready to use
- Excellent adhesion on porous and non-porous substrates
- Seamless waterproofing membrane
- Water vapour permeable

Packaging:

20 kg and 4 kg pail

Colors:

White, Grey



APPLICATION



The substrate must be sound and of sufficient strength, clean, dry and free of oil, grease or other contaminants. If required, the substrate must be mechanically cleaned.

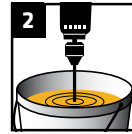

Stir Sikalastic®-590 thoroughly for 1 minute in order to achieve a homogeneous mixture. All substrates should be primed with one layer of Sikalastic®-590 diluted with 10% water. Consumption ~0.3 kg/m².

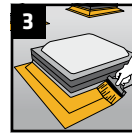

Apply first coat of Sikalastic®-590. For detailing areas, always apply them first and use Sika Reinforcement System (e.g. Sika® Reemat, Sikalastic® Fleece, etc.) for details, connections, overlaps etc.

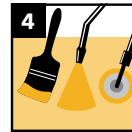

Sikalastic®-590 can be applied by brush, roller or spray.

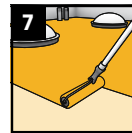
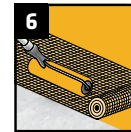
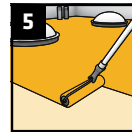

Apply Sikalastic®-590 in two to three coats and embed Sika Reinforcement System into Sikalastic®-590 for substrates with high movements or cracks as well as for details.